

# Addison

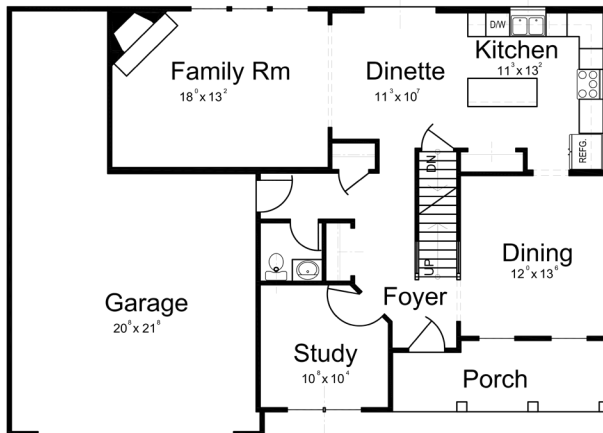

**First Floor Plan**

1,009 sq.ft. Living Area

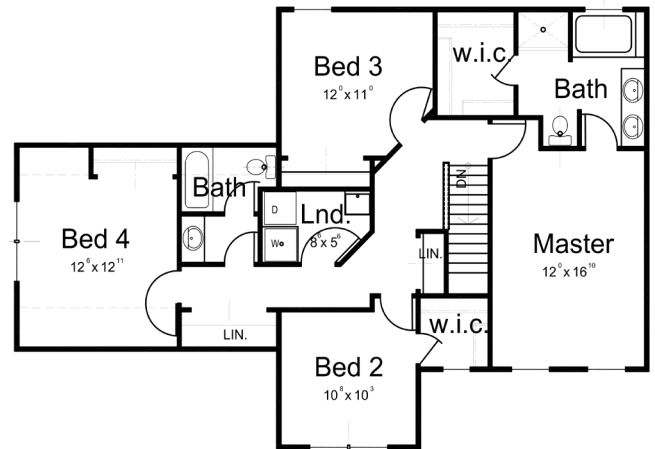

**Second Floor Plan**

1,166 sq.ft. Living Area

Addison - 2,175 sq.ft.

- 2 Story Home
- 4 Bedroom
- 2 - 1/2 Baths
- 2 Car Garage

The above home design is an artist's concept. For full details see Rea Custom Homes standards features and full set of building plans. Plans are property of Rea Custom Homes and are subject to change without notice.

Some items shown may be optional. See builder's plans and specifications for final details included.

We can modify this plan to meet you needs and show you what it looks like in full 3D. Contact us today for a consultation.



330-806-6122

[www.reacustomhomes.com](http://www.reacustomhomes.com)